

STRUCTEAVENT "R" V, "R" VA

U.S. Patent 7610729

TYPICAL GENERIC PARTS AND PIECES

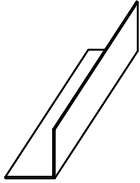

Optional galvanized mounting angle

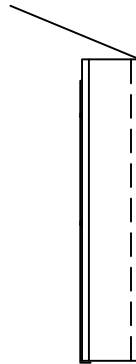

Typical Base Assembly:
Backer Plate, Roof
Mounting Flange, and
Internal Zees' at 12" o.c.

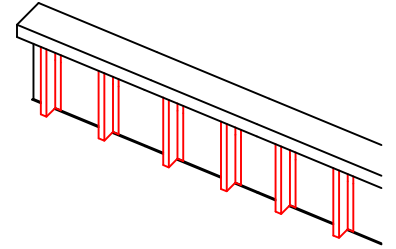

Iso of Typical
Prefabricated Base
Assembly

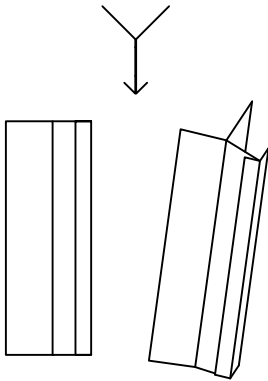

Outside Corner for Base
Assembly

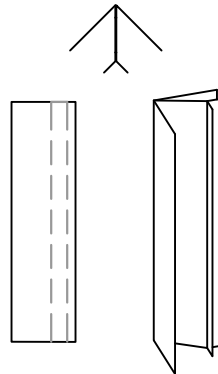

Inside Corner for Base
Assembly

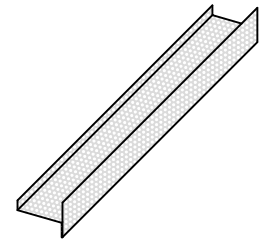

.040 Perforated
Aluminum Pre0finished
Closure



Fascia Undercover
Splice plate

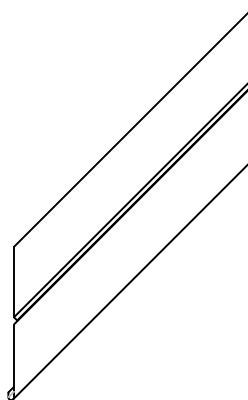

Typical Fascia with
Stiffener Bead

Material Standard Lengths are
10'0"



ACS, LLC

2550 Five Star Pkwy. Phone : 877-580-9756
Suite 116
Bessemer, AL 35022 www.acs-reps.com

DATE: 12/31/09

SHT.# ____ OF ____

DRN BY: KSK

CHK BY: KSK & HA

DWG#

X

STRUCTEAVENT "R" V, and "R" VA BASE COMPONENTS

The Structeavent "R" V and "R" VA system is easy to install and has three major components: the Structeavent Base assembly, the Structeavent Fascia, and the Structeavent Closure. The Structeavent fascia has its own splice plates.

Base Assembly:

The base assembly consists of the base angles and the zee spacers as shown, (Illustration 1). The zee spacers are factory installed at 12" on center and are used to allow for the movement of air from the base of the fascia to the appropriate vent intake location in the roof system.

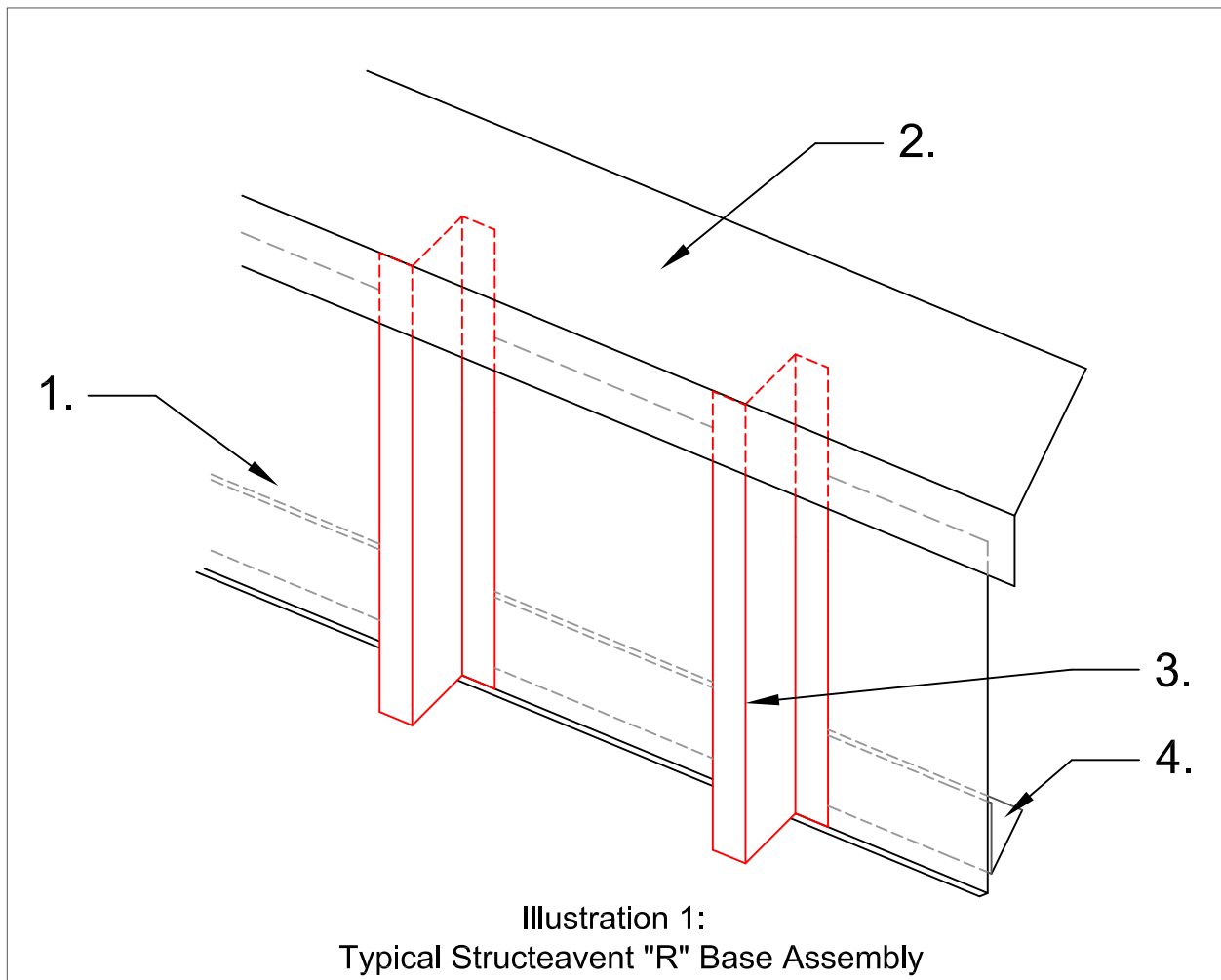

1. Galvanized base in 10 ft sections
2. Galvanized Attachment flange, to match slope of roof
3. Zee's, factory installed at 12" o.c.
4. Option 2"x2" Mounting Angle

REFERENCE DETAIL:

STRUCTEAVENT SYSTEM

STRUCTEAVENT "R" V, "R" VA

U.S. Patent 7610729

STRUCTEAVENT "R" V Vented Roof Deck Application Generic Component And Installation

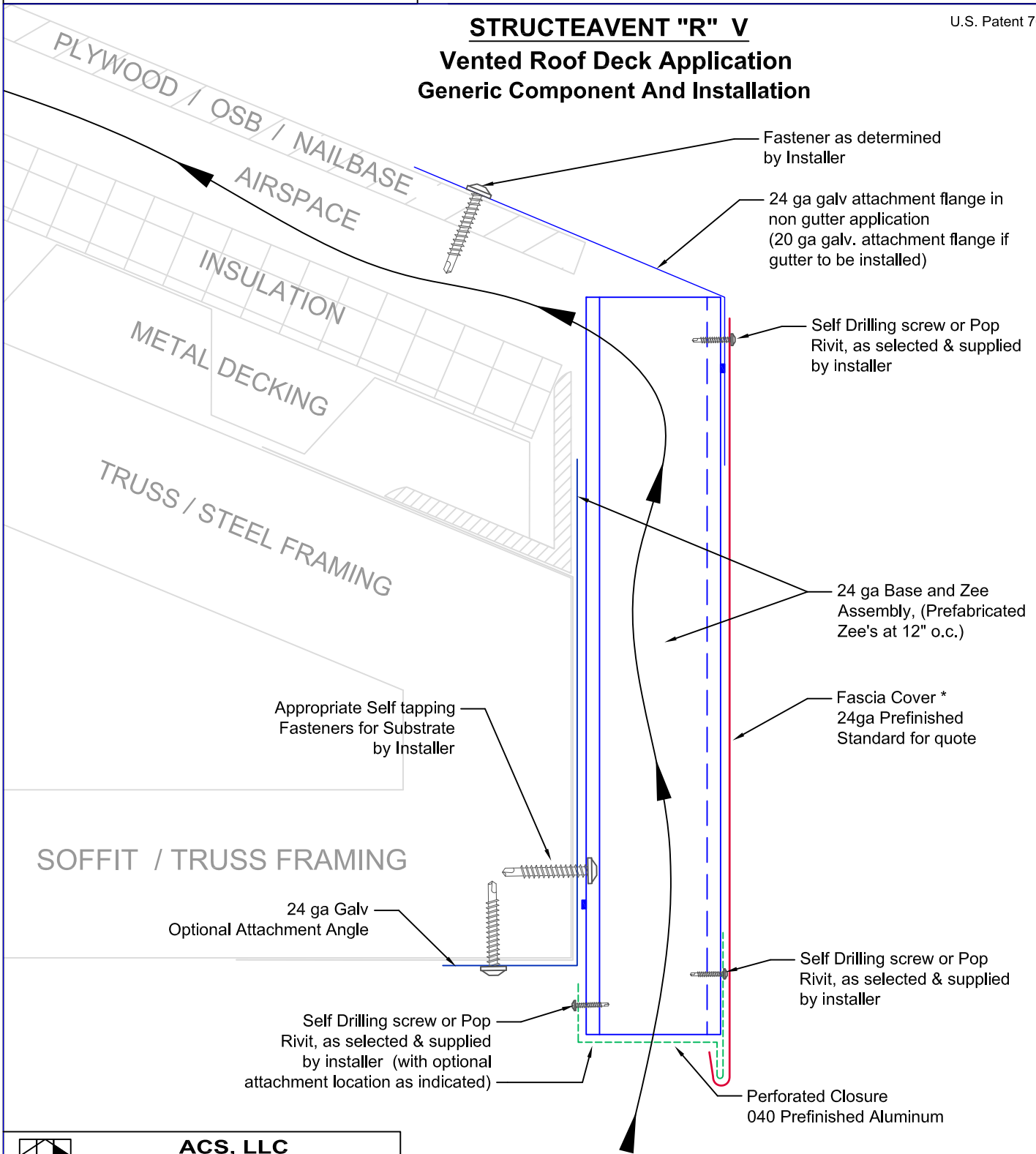

ACS, LLC
 2550 Five Star Pkwy. Phone : 877-580-9756
 Suite 116
 Bessemer, AL 35022 www.acs-reps.com

DATE: 12/23/09

SHT.# ____ OF ____

DRN BY: KSK

DWG#

CHK BY: KSK / HA

X

* Fascia greater than 9" may have stiffener rib, as determined by Architect.

8 (a).

REFERENCE DETAIL:

STRUCTEAVENT SYSTEM

STRUCTEAVENT "R" V, "R" VA

U.S. Patent 7610729

STRUCTEAVENT "R" VA Vented Attic Application Generic Component And Installation

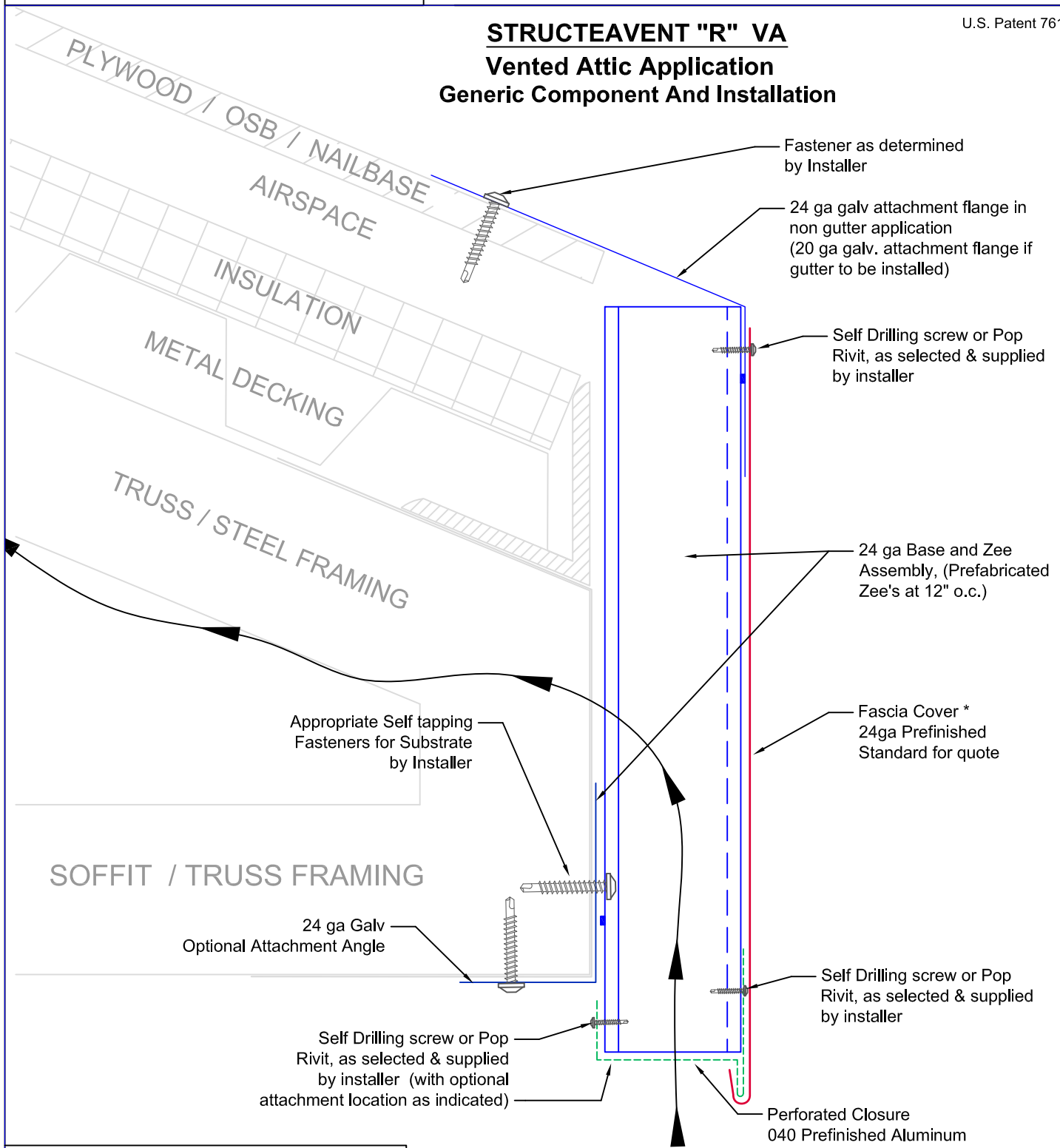

ACS, LLC
 2550 Five Star Pkwy. Phone : 877-580-9756
 Suite 116
 Bessemer, AL 35022 www.acs-reps.com

DATE: 12/23/09	SHT.#	OF
DRN BY: KSK	DWG#	X
CHK BY: KSK / HA		

* Fascia greater than 9" may have stiffener rib, as determined by Architect.

8 (b).

Optional mounting angle: In most cases the use of the optional mounting angle will be used. Install the counting angle plumb and true to the roof edge condition. Secure with selftapping screws, and appropriate thread type for securing the mounting angle to the framing as supplied. Depending on the condition and the soffit framing, the angle may be installed in the up condition as shown, or in a down condition, (installers option). It is imparitive when installing to ensure the angle is plumb and true, as the Structeavent "R" will be screw attached directly to with the mounting angle or the truss framing itself. (Shim mounting angle as necessary to maintain plumb and true level condition)

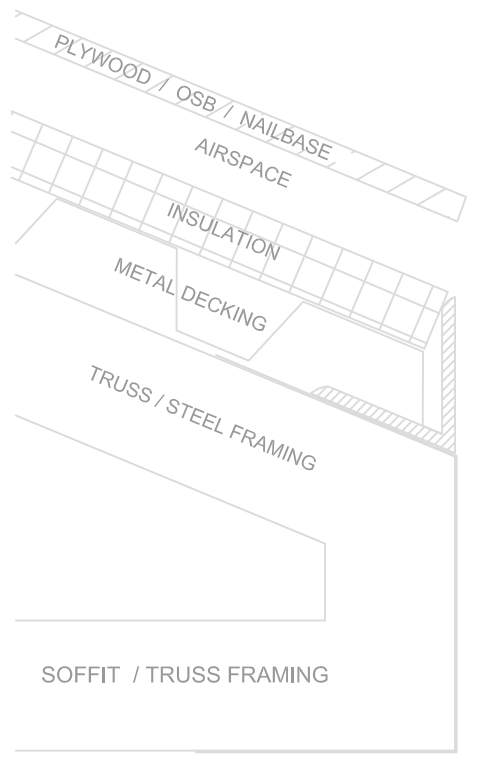

OPTIONAL ATTACHMENT ANGLE:

DEPENDING ON THE CONDITION, INSTALL THE CONTINUOUS ATTACHMENT ANGLE ON THE SUBFRAMING. USE A SELF TAPPING SCREW, WITH APPROPRIATE THREADS FOR SECURING THE ANGLE TO THE SUBSTRATE. (ie...Self Tapping Screws with wood threads, or metal threads)

ENSURE ANGLE IS INSTALLED TO ALLOW FLUSH ATTACHMENT OF THE STRUCTEAVENT®. THE ANGLE MAY BE ADJUSTED IN AND OUT, TO ALLOW FOR PLUMB AND TRUE VERTICLE AND HORIZONTAL INSTALLATION OF THE STRUCTEAVENT® SYSTEM.

When mounting the Structeavent "R" to the structure, it is the installers option on if and how to mount the Structeavent "R" base assembly. Option #1. The 2"x2" mounting angle, if requested is supplied, (loose shipped), with the base assembly. As previously described this angle is installed prior to the Structeavent "R" base assembly. Option #2. As shown in the Optional Segmented base attachment, can be used after the base assembly has been installed. This clip is made from galvanized metal. The angle would be attached to the subframing, at each joist location, with the flat side of the angle being flush against the backside of the base assembly. The base assembly would then be attached to the angle through the front or back. Installer to determine which option, (if either), is to be used when fabrication order is placed.

2"x2" Optional Mounting Angle

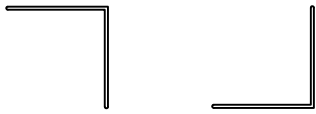

OPTIONAL BASE ATTACHMENT MOUNTING ANGLE, (24 GA.) SIZE 2"X2". FOR ATTACHMENT TO BACK SIDE OF STRUCTEAVENT AND BOTTOM OF SOFFIT SUPPORT FRAMING.

Optional 2"x2" Continuous Mounting Angle

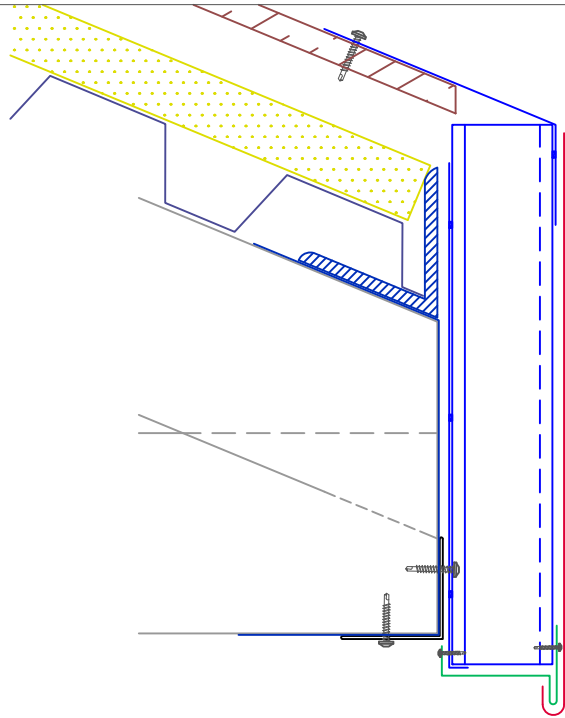

OPTIONAL SEGMENTED ATTACHMENT:



CLIP MADE FROM ANGLED LIGHT GAUGE METAL. SIZE ACCORDING TO NEED. TYPICAL SIZE 3"X3". BREAK OR BEND TO 90 DEGREE FOR ATTACHMENT TO BACK SIDE OF STRUCTEAVENT AND SIDE OF ROOF FRAMING. SPACE AS NEEDED

Optional Segmented Additional Attachment

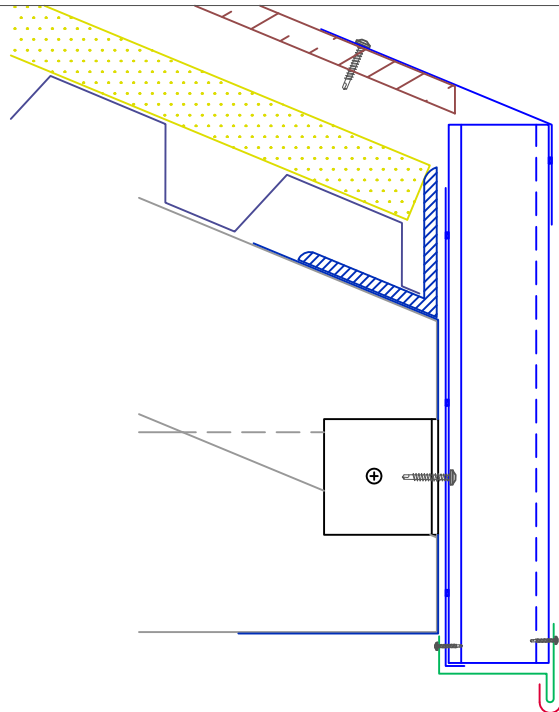

STRUCTEAVENT BASE ASSEMBLY:

After determining if the Optional Mounting Angle is required, the basic attachment of the Structeavent "R" base sections are shown below. The 10' base assembly of the Structeavent "R" can be installed in two different manners, (1). When installing a subsequent base assembly, lap the piece being installed 2" over the previously installed piece. Attach through the lap and into the structure the minimum fasteners as indicated. (2). Upon completion of the first base assembly, install subsequent pieces with the leading edge butted tightly to the previously installed base assembly. (If required to maintain level condition shim as necessary under the mounting flange)

Attach the Base assembly into the mounting angle or the sub framing through each Zee flange, using the appropriate self tapping fastener.

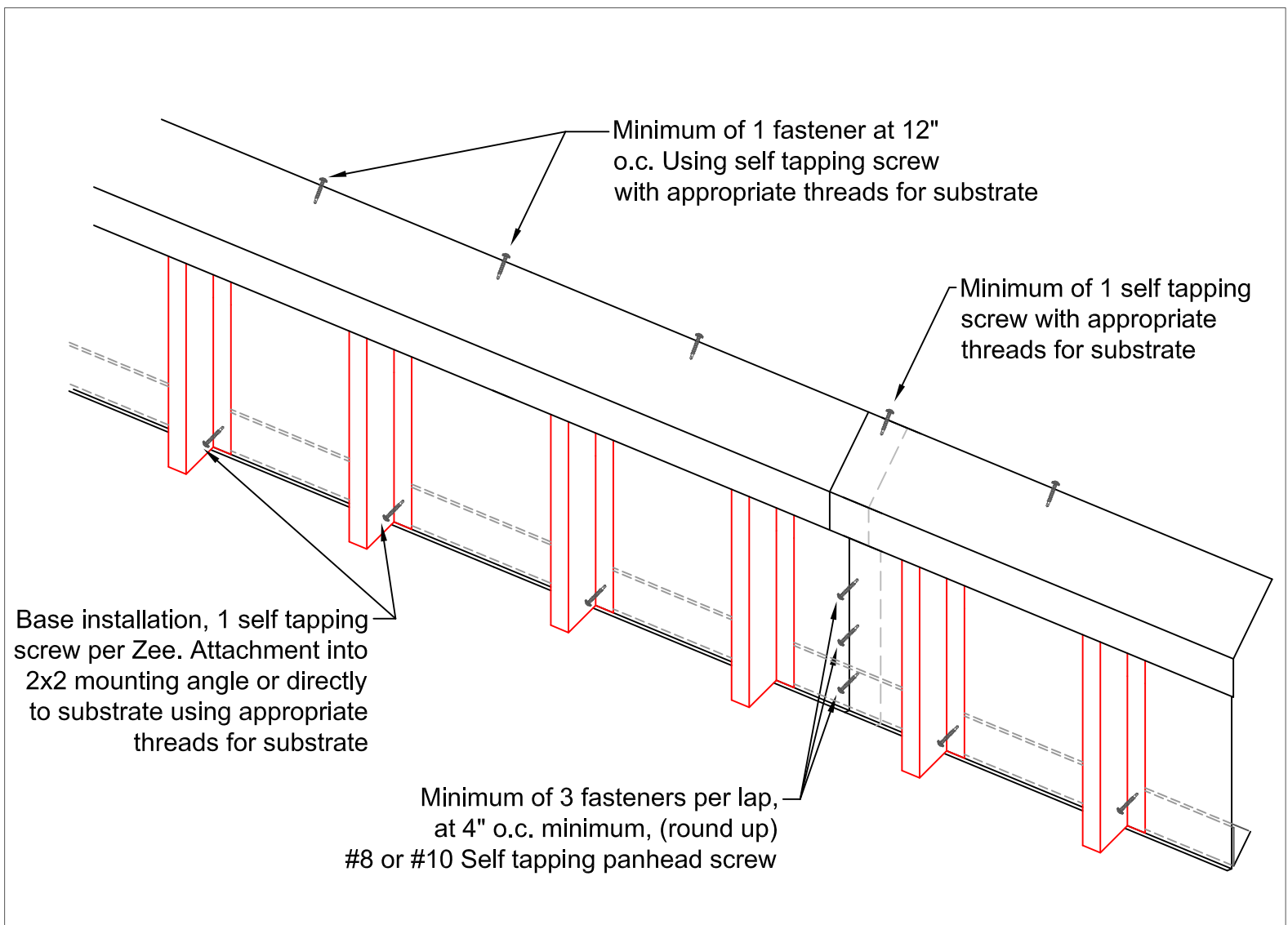

OUTSIDE and INSIDE Base Corner Installation: After completing the installation of the base sections, at the condition of an outside or inside corner, trim excess material as required for the base sections. (Shim as required to maintain level installation). In both an inside and outside corner condition, slide base splice up and under the sloped attachment flange and secure to both base sections as shown in illustration.

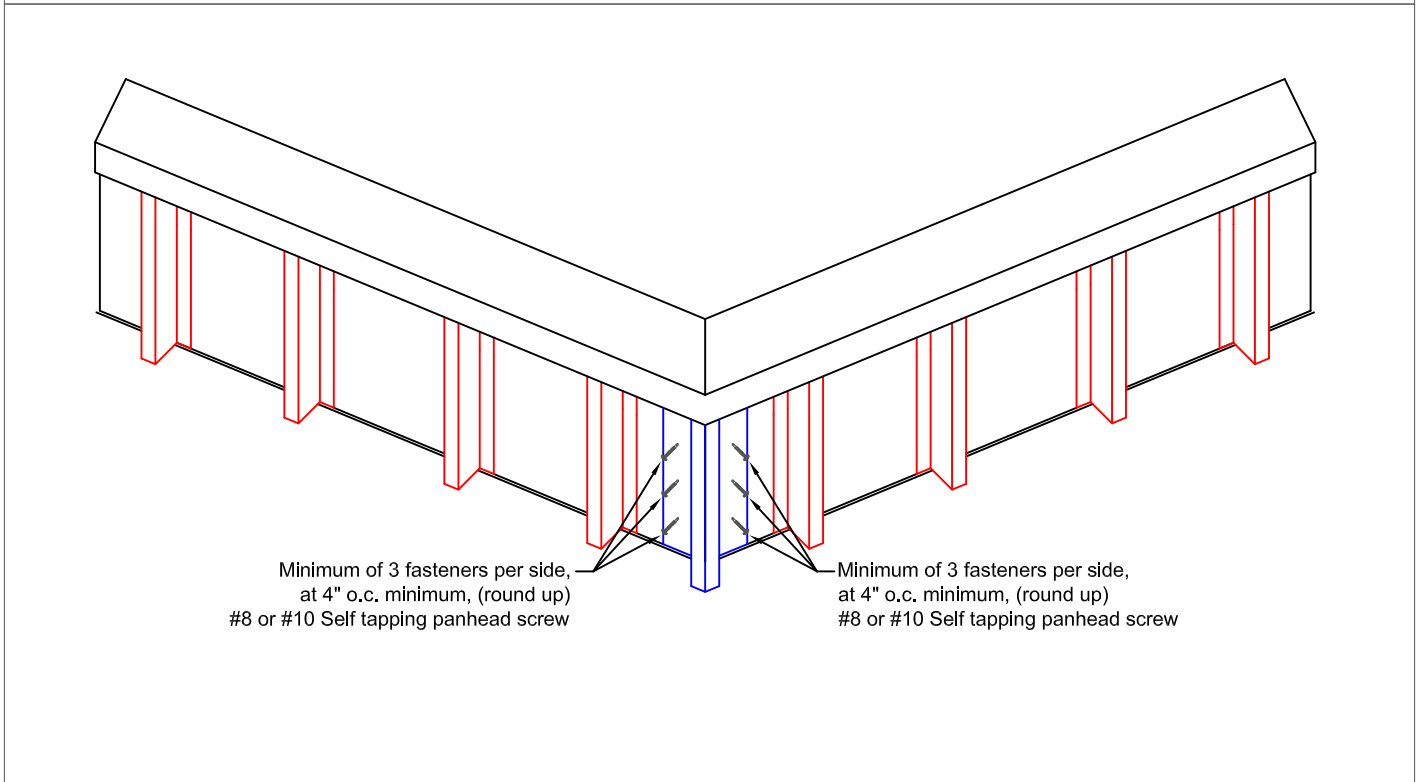
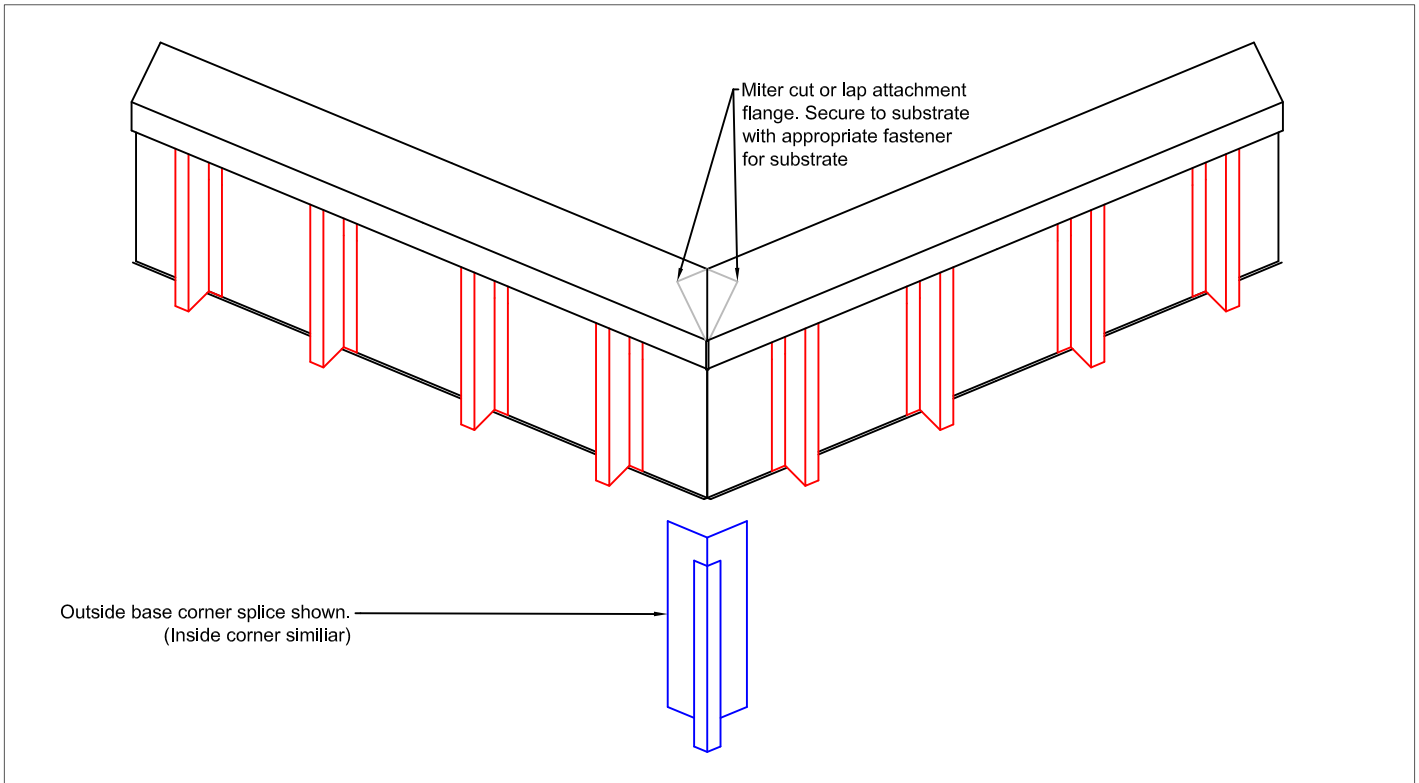

Upon completion of the installation of the Structeavent base assembly, the installer should inspect and confirm the base has been installed true and correct in the proper vertical and horizontal planes. This is the point that corrections can most easily be made.

If the base exhibits any up and down or in and out of the vertical or horizontal planes, correct before proceeding with closure and fascia installation. Upon determining the base is in an acceptable condition, the fascia and closure can now be installed. Care should be taken when transporting and installing the fascia and closure to avoid scratching the Kynar finish. Upon completion, we recommend using a touch up paint, if required, to provide longer performance and a more complete finish. Touch up paints may be obtained locally.

The aluminum closure, (if vented assembly), is installed first. This will fit snugly over the bottom of the base and zee sections. Attach closure using panhead screw or pop rivets. Attach at 24" on center on the back side of the Structeavent base, and at every Zee on the front of the base assembly.

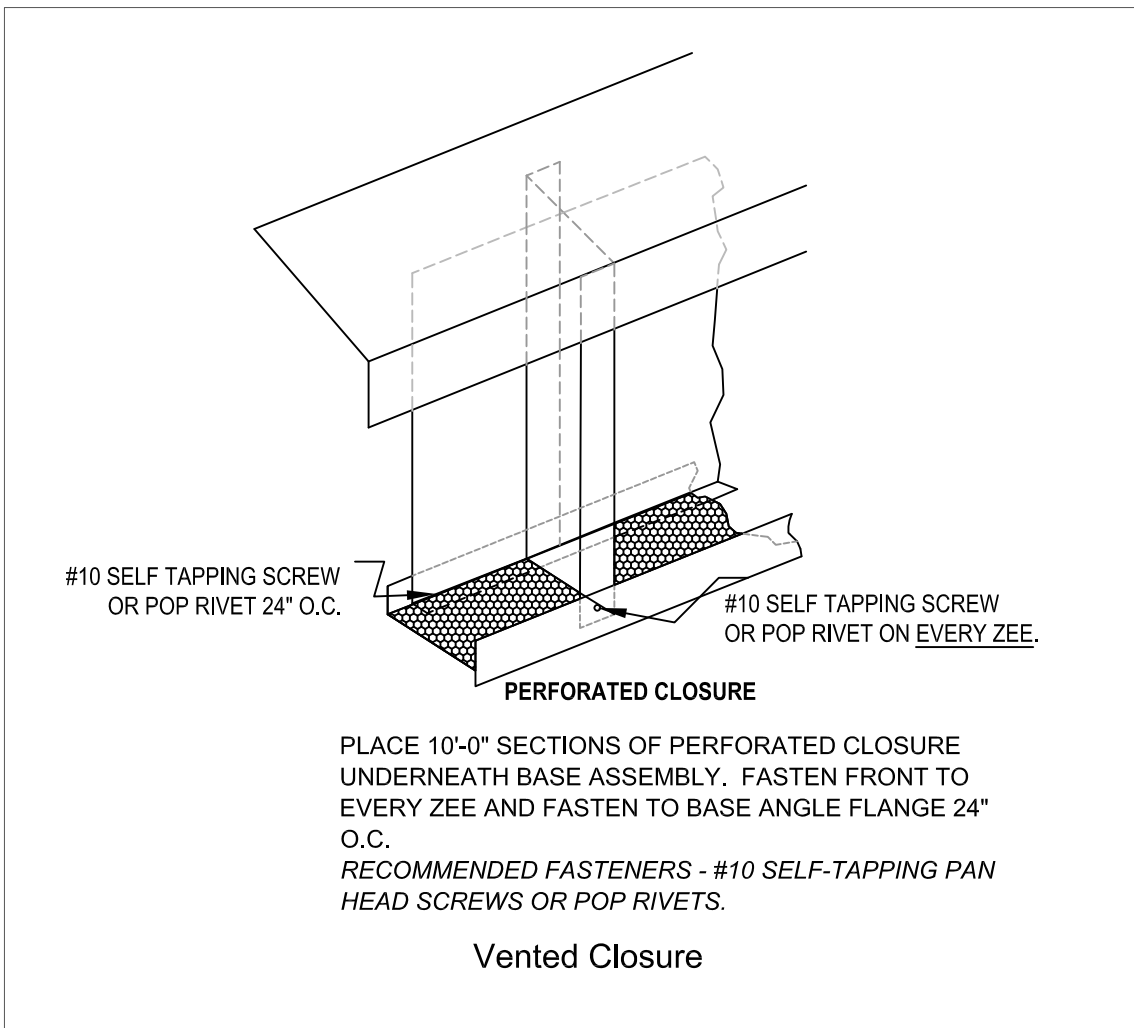

The Fascia is pre fabricated, based on the dimension supplied to manufacture the base. After installation of the vented closure, hook the bottom edge of the fascia to the drip edge of the vented closure, and attach the fascia at each zee.

For ease of installation the splice plate can be attached to a section of the fascia plate prior to being installed on the base assembly. (Illustration X)

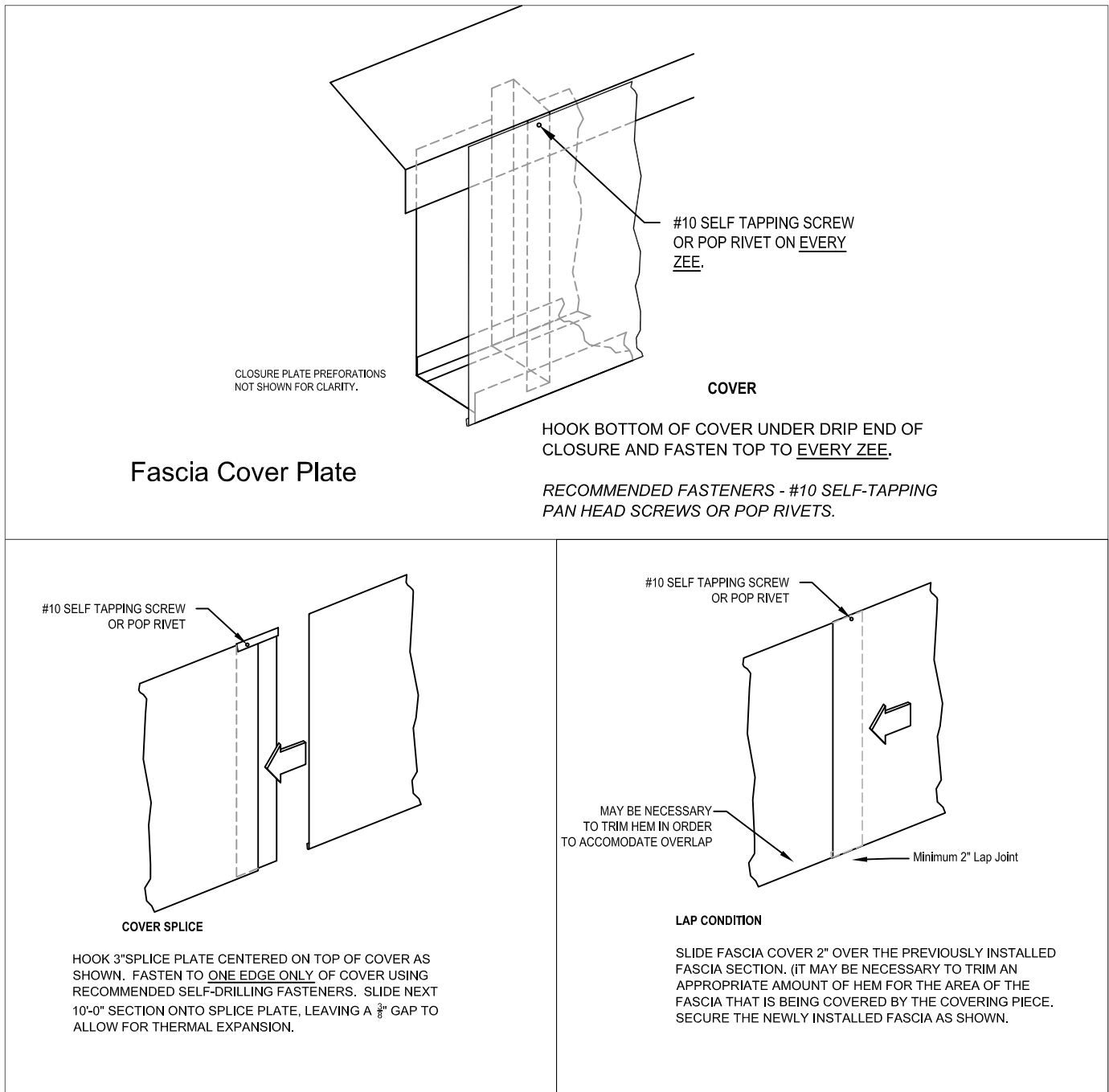

The finishing of the fascia at corners, end runs, walls etc...are the same as they would be when covering wood blocking, using standard field finishing folds and cuts in accordance with standard sheet metal techniques and SMACNA.

Available Field Options.

Field Formable inside and outside corner pieces, from 2'0" flat fascia stock.

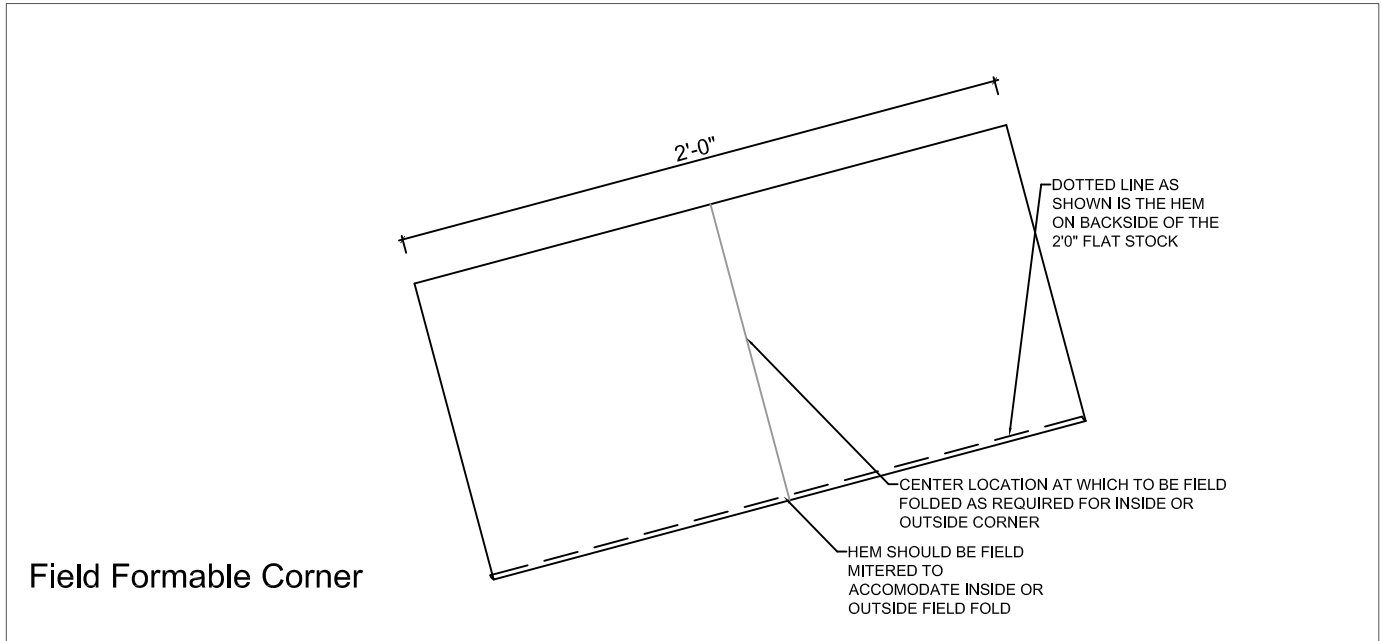

Field formed inside / outside corner piece, Install as normal with splice plate or lap on either end, when connecting to standard fascia.

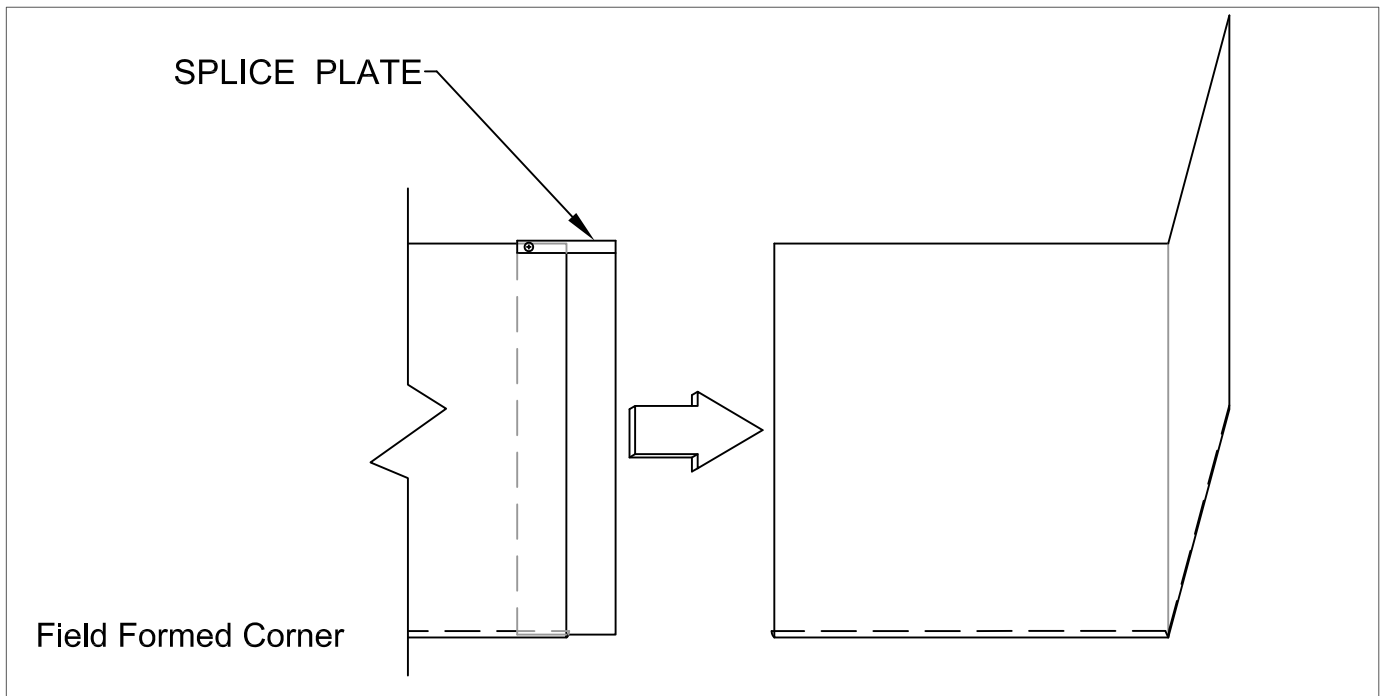

The corner attachment with a splice plate, or lap as required. Corner Fascia is attached as standard practice to every Zee.